

FORGED CARBON STEEL Y STRAINER 800 LBS



Size : DN 1/4" to 2"
Ends : Female - Female BSP or NPT, Socket Welding
Min Temperature : - 29°C
Max Temperature : + 425°C
Max Pressure : 138 Bars
Specifications : With draining cap
Removable stainless steel filter

Materials : Forged carbon steel

FORGED CARBON STEEL Y STRAINER 800 LBS

SPECIFICATIONS :

- With draining cap
- Removable stainless steel filter
- Respect the flow direction indicated by the arrow
- Horizontal or vertical position with descendant fluid
- Mesh 8/10° mm (800 μ)
- 800 lbs type

USE :

- Petroleum industry, steam, high pressure
- Min and max Temperature Ts : - 29°C to + 425°C
- Max Pressure Ps : 138 bars (see graph)

PRESSURE / TEMPERATURE RELATION :

Pressure (bar)	136,2	136,2	136,2	124,1	120,7	116,6	110	100,7	98,6	97,9	92,7	75,9
Temperature (°C)	-29	0	38	93,5	149	204,5	260	315,5	343,5	371	399	425

PRESSURE / TEMPERATURE GRAPH :

Pressure (Bars)

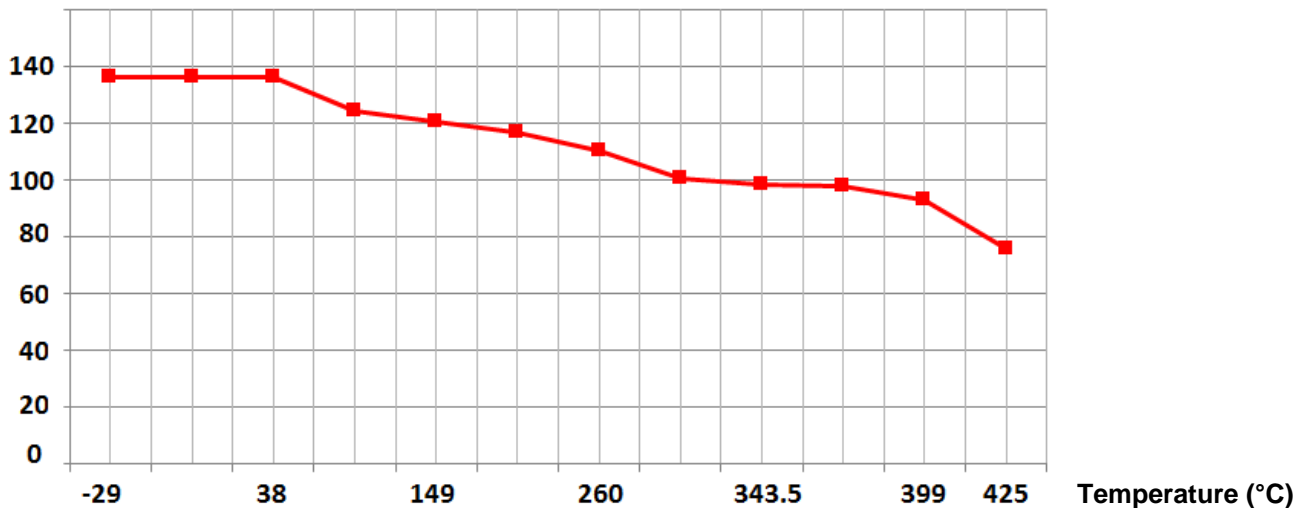

FORGED CARBON STEEL Y STRAINER 800 LBS

HEAD LOSS GRAPH :

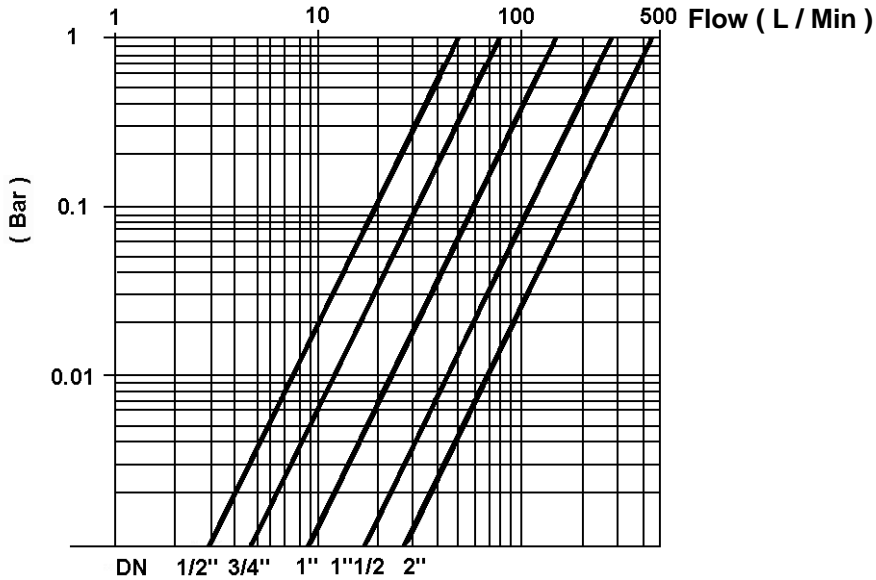

RANGE :

- Forged carbon steel Y strainer threaded female BSP **Ref. 231** from DN 8 to DN 50 (NPS 1/4" to DN 2")
- Forged carbon steel Y strainer Socket Welding ends **Ref. 232** from DN 8 to DN 50 (NPS 1/4" to DN 2")
- Forged carbon steel Y strainer threaded female NPT **Ref. 234** from DN 8 to DN 50 (NPS 1/4" to DN 2")

FORGED CARBON STEEL Y STRAINER 800 LBS

MATERIALS:

DN 8 – 40 (NPS 1/4" - 1"1/2)

DN 50 (NPS 2")

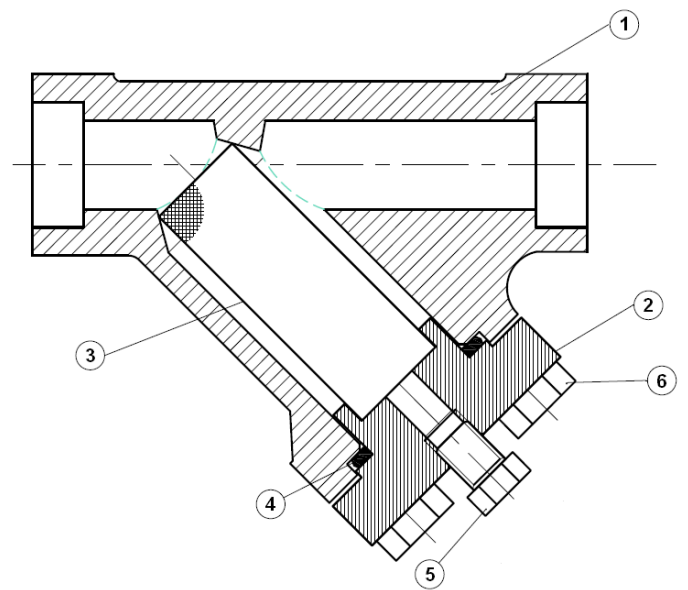
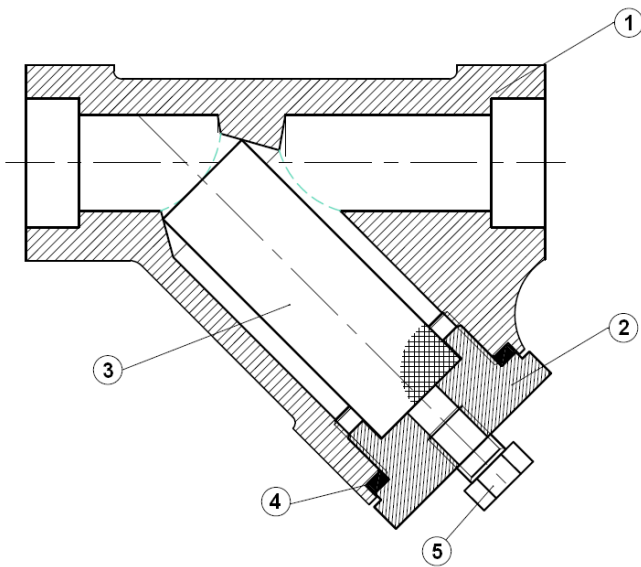

Item	Designation	Materials
1	Body	ASTM A105 N
2	Bonnet	ASTM A105 N
3	Filter	SS ASTM A240 316L
4	Gasket	SS 316 + graphite
5	Cap	ASTM A105 N
6	Screw (only for DN50)	ASTM A193 B7

FORGED CARBON STEEL Y STRAINER 800 LBS

SIZE (in mm) :

DN 8 – 40 (NPS 1/4" - 1"1/2)

DN 50 (NPS 2")

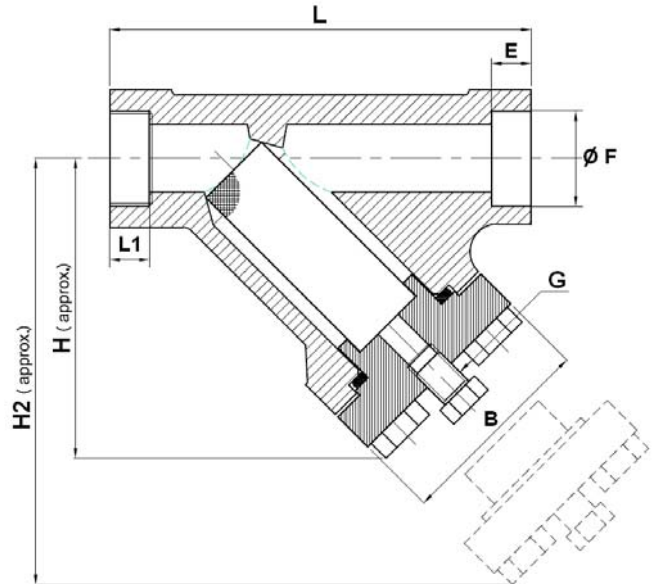
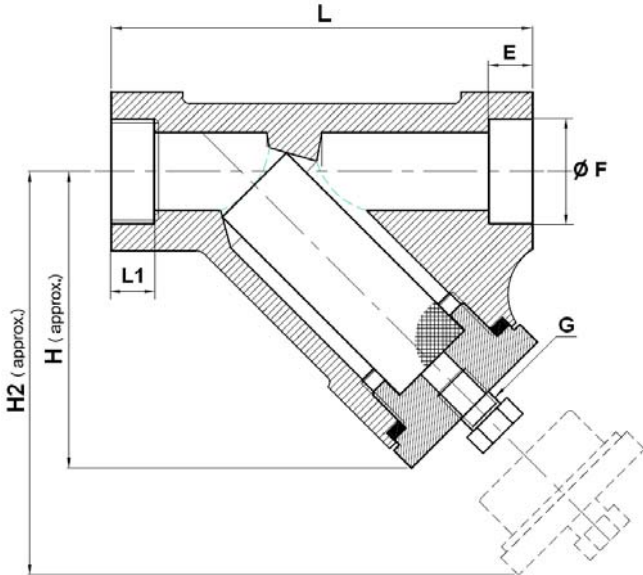

Filter size :

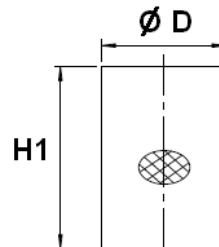

Ref.	DN (mm)	8	10	15	20	25	32	40	50
	NPS (")	1/4"	3/8"	1/2"	3/4"	1"	1"1/4"	1"1/2"	2"
231	L	90	90	90	110	130	160	160	160
	H	60	60	60	75	93	120	120	145
	H2	105	105	105	140	155	195	195	205
232	G (NPT)	1/4"	1/4"	1/4"	1/4"	1/4"	1/4"	1/4"	1/2"
234	B	/	/	/	/	/	/	/	90x90
234	Ø D	18	18	18	22	28	41,5	41,5	49,5
	H1	41	41	41	60	75	100,5	100,5	100,5
231/234	L1	10	13	14	16	20	22	22	26
232	E (SW)	10	10	10	14	14	14	14	16
	Ø F (SW)	14.2	17.6	21.72	27.05	33.78	42.54	48.64	61.11
231/232/234	Weight (Kg)	0.85	0.78	0.73	1.22	1.88	4.75	4.45	6.5

FORGED CARBON STEEL Y STRAINER 800 LBS

STANDARDS :

- Fabrication according to ISO 9001 :2008
- DIRECTIVE 97/23/CE : CE N° 1115
Risk category III Module H
- Designing according to ASME B16.34
- Tests according to API 598
- Threaded NPT female ends according to ASME B2.1
- Threaded BSP cylindrical female ends according to ISO 7/1 Rp
- ATEX Group II Category 2 G/2D Zone 1 & 21 Zone 2 & 22 (optional marking)

INSTALLATION POSITIONS :

Horizontal position

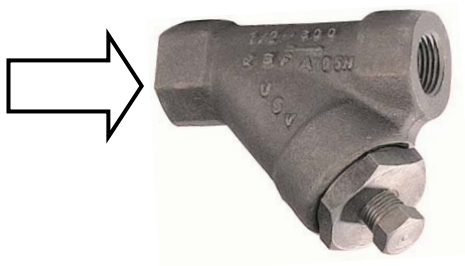

Vertical position (descendand fluid)



ADVICE : Our opinion and our advice are not guaranteed and SFERACO shall not be liable for the consequences of damages.
The customer must check the right choice of the products with the real service conditions.

FORGED CARBON STEEL Y STRAINER 800 LBS**INSTALLATION INSTRUCTIONS****GENERAL GUIDELINES :**

- Ensure that the strainers to be used are appropriate for the conditions of the installation (type of fluid, pressure and temperature).
- Be sure to have enough valves to be able to isolate the sections of piping as well as the appropriate equipment for maintenance and repair.
- Ensure that the strainers to be installed are of correct strength to be able to support the capacity of their usage.
- **Installation of all circuits should ensure that their function can be automatically tested on a regular basis (at least two times a year).**

INSTALLATION INSTRUCTIONS :

- **Before installing the strainers, clean and remove any objects from the pipes** (in particular bits of sealing and metal) which could obstruct and block the strainers.
- **Ensure that both connecting pipes either side of the strainer (upstream and downstream) are aligned (if they're not, the strainer may not work correctly).**
- **Make sure that the two sections of the pipe (upstream and downstream) match, the strainer unit will not absorb any gaps. Any distortions in the pipes may affect the tightness of the connection, the working of the strainer and can even cause a rupture.** To be sure, place the kit in position to ensure the assembling will work.
- The theoretical lengths given by ISO/R7 for the tapping are typically longer than required, the length of the thread should be limited, and **check that the end of the tube does not press right up to the head of the thread.**
- **Never use a vice to tighten the fixings of the strainer.**
- **If sections of piping do not have their final support in place, they should be temporarily fixed. This is to avoid unnecessary strain on the strainer.**
- **Fluids in the strainer must not contain solid objects (it could damaged the seat).**